

120 kHz side scan transducer

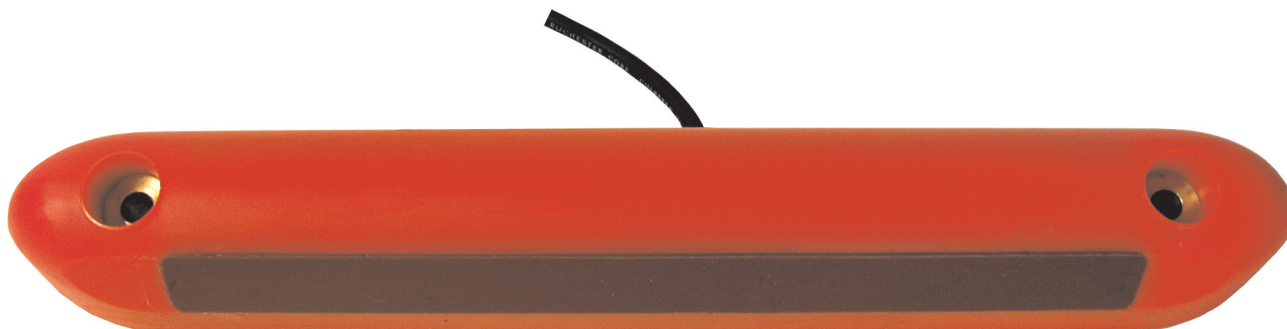

Introduction

The 120-2x50 is a side scan transducer with a narrow longitudinal and a wide transverse beam.

Order number

KSV- 088606

Technical specifications

Resonant frequency.....	120 kHz	Maximum pulse power input	1000 W
Longitudinal beamwidth	1.9 deg	Maximum continuous power input	10 W
Transversal beamwidth	55.0 deg	Maximum transducer depth	10 m
Directivity:		Cable length	20 m
D	350	Weight without cable	3.5 kg
DI=10logD	25.5	Weight with cable	5.5 kg
Gain.....	23.3 dB	Storage temperature	+70 to -40° C
Side lobes	less than -15 dB		
Back radiation	less than -30 dB		
Near-field (L^2/λ)	12 m		
L = active length; λ = wavelength			
Impedance:			
Nominal value	60 ohm		
Maximum variation in Z 	45 to 80 ohm		
Maximum variation in phase angle	±30 deg		

Data

Admittance

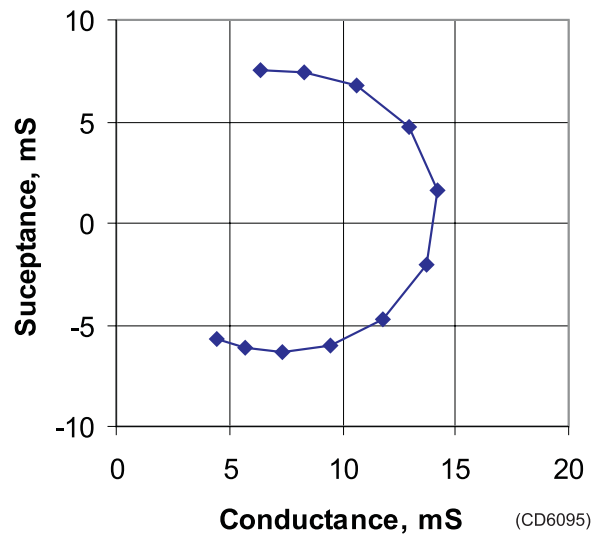

Installation

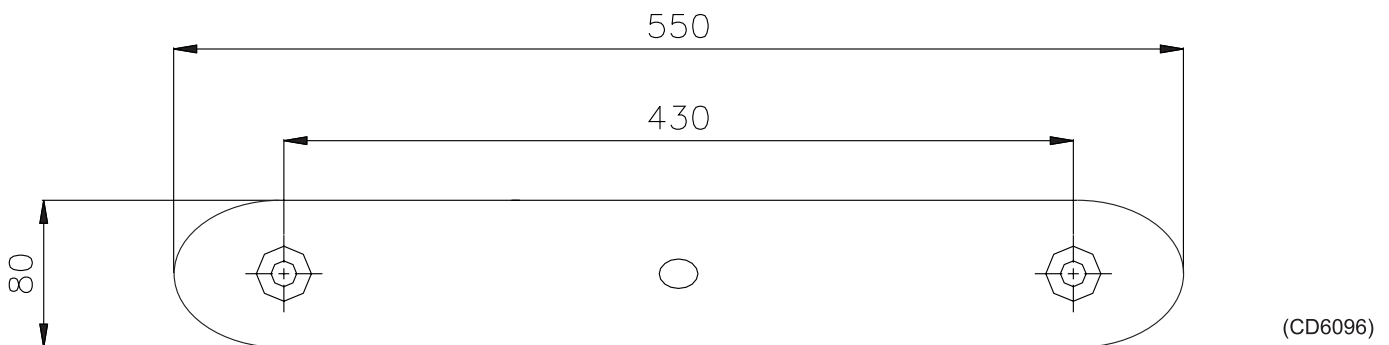
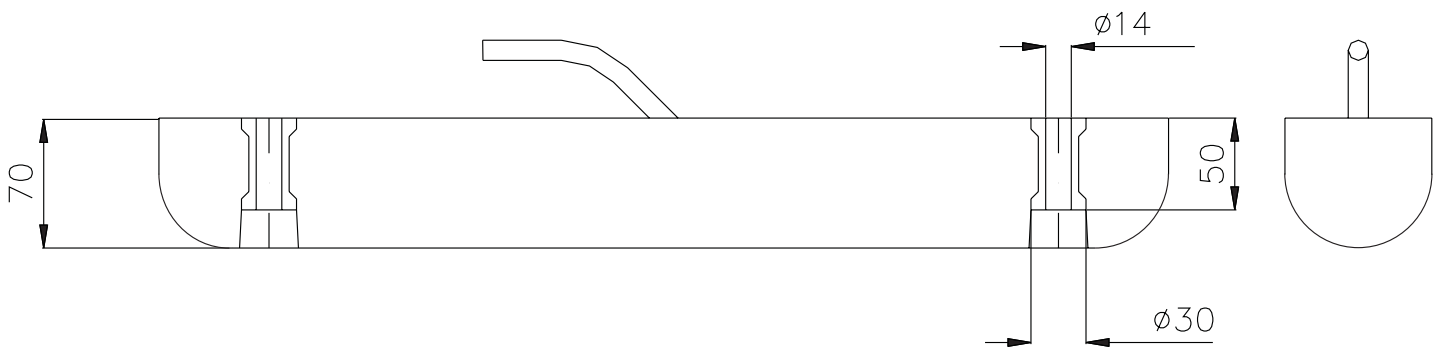

Manufacturer:

Simrad AS

Strandpromenaden 50

P.O.Box 111

N-3191 Horten

Telephone: +47 33 03 40 00

Telefax: +47 33 04 29 87

Internet: www.simrad.com